

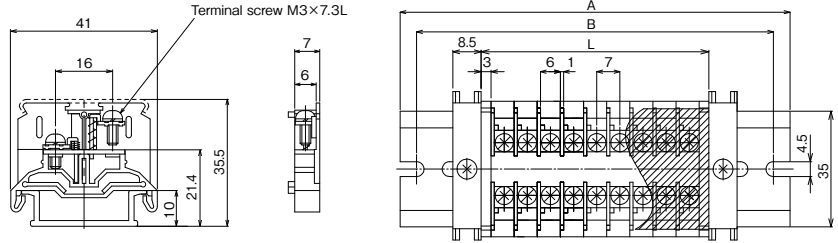

PTU-10

M3/1.25mm² 15A

RoHS



■ Applicable solderless terminal

■ Rating

Applicable wire / Rated current	UL, CSA	TÜV	Terminal screw	Tightening torque
0.75mm ² / 1.25mm ²	AWG20~16 (stranded)	AWG20~16 (stranded)	M3×7.3L	0.5~1.2N·m
800V/11A / 800V/15A	600V/15A	600V/15A	Pan head sems(±)	

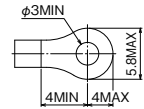

Total length of terminal block (L) = Terminal width (7mm) × No. of poles (□P) + End plate × 2 (6mm)

No. of poles (P)	1	2	3	4	5	6	7	8	9	10	11	12	13	14	15
Terminal length (L)	13	20	27	34	41	48	55	62	69	76	83	90	97	104	111
Rail length (A)	60	60	60	80	80	80	100	100	100	120	120	140	140	140	160
Mounting pitch (B)	50	50	50	70	70	70	90	90	90	110	110	130	130	130	150

Assembly terminal block
(assembled at the factory and shipped)

Order format:

PTUL2-10-□P (□: No. of poles)

No. of poles (P)	16	17	18	19	20	21	22	23	24	25	26	27	28	29	30
Terminal length (L)	118	125	132	139	146	153	160	167	174	181	188	195	202	209	216
Rail length (A)	160	160	180	180	180	200	200	200	220	220	220	240	240	240	260
Mounting pitch (B)	150	150	170	170	170	190	190	190	210	210	210	230	230	230	250

Terminal block	End plate	Cover	Name plate	Rail	Stopper	Short bar
PTU-10 (6g)	PTU-10L2 (2g)	CA-34 (34g)	AM-10 (9g)	DAV4 (191g)	HDV-1 (18g)	SB(R)7A-※, □B(R)7A-※
Sales lot(100)	Sales lot(100)	Sales lot(20)	Sales lot(50)	Sales lot(100)	Sales lot(100)	—

※Short bar is option.

PTU-20

M3.5/2mm² 22A

RoHS

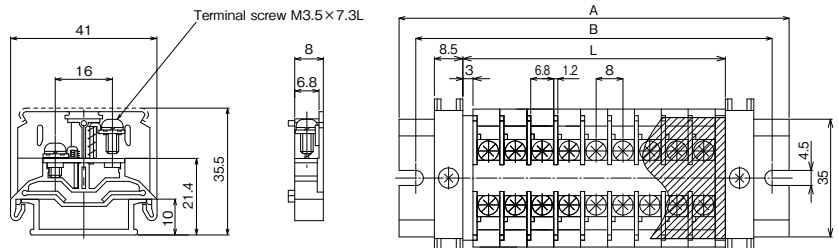

■ Applicable solderless terminal

■ Rating

Applicable wire / Rated current	UL, CSA	TÜV	Terminal screw	Tightening torque
1.25mm ² / 2mm ²	AWG16~14 (stranded)	AWG20~14 (stranded)	M3.5×7.3L	0.8~1.4N·m
800V/16A / 800V/22A	600V/19A	600V/22A	Pan head sems(±)	

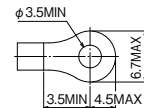

Terminal length of terminal block (L) = Terminal width (8mm) × No. of poles (□P) + End plate × 2 (6mm)

No. of poles (P)	1	2	3	4	5	6	7	8	9	10	11	12	13	14	15
Terminal length (L)	14	22	30	38	46	54	62	70	78	86	94	102	110	118	126
Rail length (A)	60	60	80	80	80	100	100	120	120	120	140	140	160	160	160
Mounting pitch (B)	50	50	70	70	70	90	90	110	110	110	130	130	150	150	150

Assembly terminal block
(assembled at the factory and shipped)

Order format:

PTUL2-20-□P (□: No. of poles)

No. of poles (P)	16	17	18	19	20	21	22	23	24	25	26	27	28	29	30
Terminal length (L)	134	142	150	158	166	174	182	190	198	206	214	222	230	238	246
Rail length (A)	180	180	200	200	200	220	220	240	240	240	260	260	280	280	280
Mounting pitch (B)	170	170	190	190	190	210	210	230	230	230	250	250	270	270	270

Terminal block	End plate	Cover	Name plate	Rail	Stopper	Short bar
PTU-20 (7g)	PTU-20L2 (2g)	CA-34 (34g)	AM-10 (9g)	DAV4 (191g)	HDV-1 (18g)	SB(R)8A-※, □B(R)8A-※
Sales lot(100)	Sales lot(100)	Sales lot(20)	Sales lot(50)	Sales lot(100)	Sales lot(100)	—

※Short bar is option.