

Order form  
PCA7-□□20-□

| Maker & Connector |   |
|-------------------|---|
| 1H                | Maker/HIROSE<br>Form/HIF3BA-20PA-2.54DSA (63) |
| 1T                | Maker/OMRON<br>Form/XG4A-2031                 |

| The contents of printing type (Fig.1) |  |
|---------------------------------------|--|
| None                                  | Upper terminal B1-B10<br>Lower terminal A1-A10     |
| M                                     | Upper terminal 2·4···20<br>Lower terminal 1·3···19 |



⑨ 【Fig.1】 The contents of printing type

|      |            |  |
|------|------------|--|
| None | Name plate |  |
|      | Name seal  |  |
| M    | Name plate |  |
|      | Name seal  |  |

Applicable solderless terminal

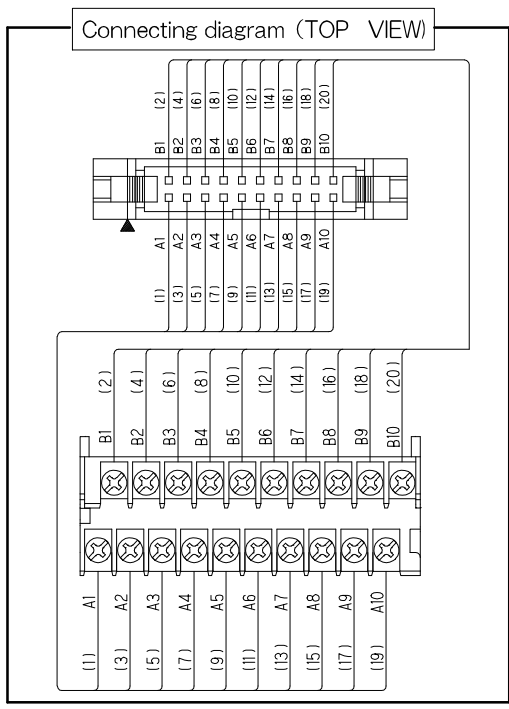
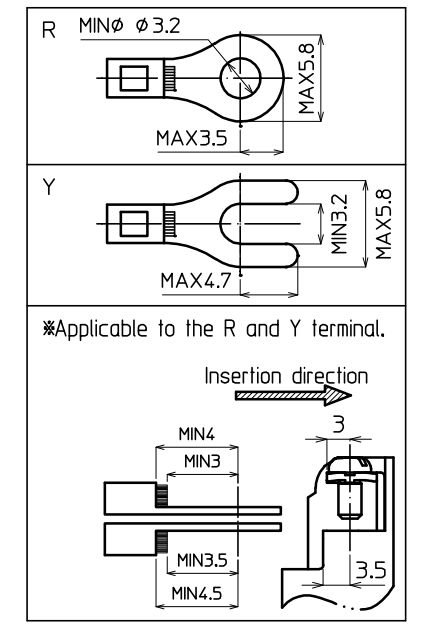

Specification

| No. | Description      | Material              | Surface Treatment | Remarks                         |
|-----|------------------|-----------------------|-------------------|---------------------------------|
| 1   | Terminal Block   |                       |                   |                                 |
| a   | Base             | Modified PPE (Black)  |                   | UL94V-0                         |
| b   | Conductive Plate | Copper alloy          | Sn                |                                 |
| c   | Washer           | Steel                 | Zn                |                                 |
| d   | Spring           | SUS                   |                   | *Springs is Built-in            |
| e   | Terminal Screw   | Steel                 | Zn                |                                 |
| f   | Screw            | Steel                 | Zn                |                                 |
| g   | Nut              | Steel                 | Zn                |                                 |
| 2   | Cover            | Polycarbonate (Clear) |                   | UL94V-2                         |
| 3   | Upper case       | Modified PPE (Black)  |                   | UL94V-0                         |
| 4   | Lower case       | Modified PPE (Black)  |                   | UL94V-0                         |
| 5   | Lock button      | POM (yellow)          |                   |                                 |
| 6   | Spring           | SUS                   |                   |                                 |
| 7   | Substrate        | Glass epoxy           |                   |                                 |
| 8   | Connector        |                       |                   | Another description             |
| 9   | Name Plate       |                       |                   |                                 |
| 10  | Name seal        |                       |                   |                                 |
| 11  | Seal of form     |                       |                   |                                 |
| 12  | Screw            | Steel                 | Zn                | *Tightening from the lower case |
| 13  | Rail DIN35mm     |                       |                   | * Optional                      |

Rates

|                               |                                       |
|-------------------------------|---------------------------------------|
| Rating voltage                | 125 V                                 |
| Rating current                | 1 A                                   |
| Insulation resistance         | 100MΩ or above (With DC500V)          |
| Withstand voltage             | AC500V / 1minute                      |
| Connectable wire              | 1.25 mm <sup>2</sup> / MAX            |
| Size of terminal screw        | M3X6L                                 |
| Standard tightening torque    | 0.8N·m                                |
| Operating ambient temperature | -15~+60℃(No freezing or condensation) |
| Relative humidity             | 45~85%                                |

Weight 110g

How to move the unit attached to the DIN (35-mm width) rail

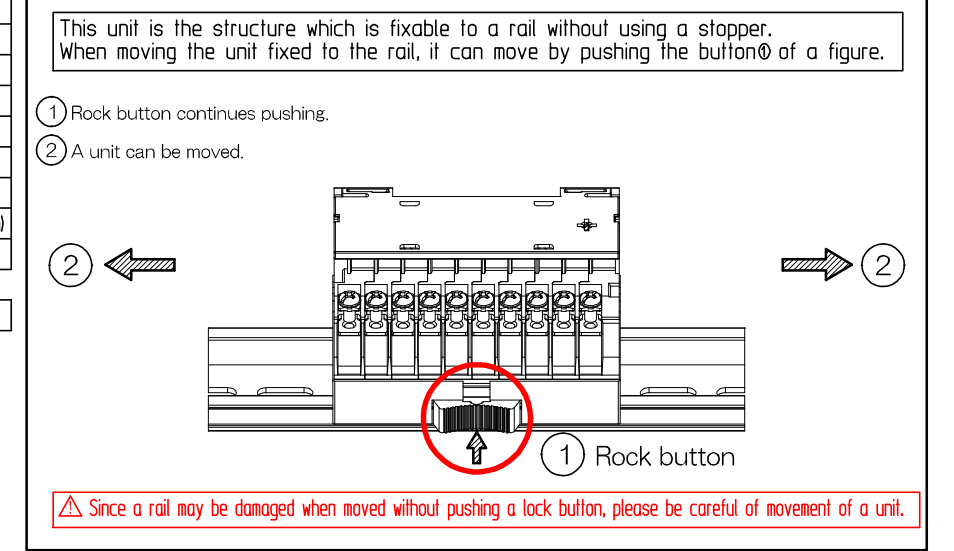

⚠ Since a rail may be damaged when moved without pushing a lock button, please be careful of movement of a unit.

参考図

|   |                              |                |
|---|------------------------------|----------------|
| Connector changed (HIF3BA-20PA-2.54DSA (71) → HIF3BA-20PA-2.54DSA (63)) | 2023/3/7                     | WATANABE       |
| 改番 REV.   | 訂正記事 DESCRIPTION OF REVISION | 年月日 DATE 担当 BY |

|  |                                   |                  |             |  |
|--|-----------------------------------|------------------|-------------|--|
| 承認 APPROVED<br>菅沼<br>2023/03/07            | 検図 CHECKED<br>小松(亮)<br>2023/03/07 | 製図 DRAWING<br>渡辺 | 設計 DESIGNED | 名称 TITLE<br>PCA7-□□20-□<br>外觀寸法図                       |
| TOYOGIEN<br>東洋技研株式会社<br>TOYOGIKEN CO.,LTD. |                                   |                  |             | 複写サイズ A3<br>単位 UNIT mm<br>尺度 SCALE 1:1<br>公差 TOLERANCE |
|  |                                   |                  |             | 図番 DRAWNG No.<br>TA16243-01<br>REV. 1<br>SHEET 1/1     |