

BOXTM-220L

IP67

Lid height: Low type ▶



Weight: 309g
Sales lot: 1pc

BOXTM-220H

Lid height: High type ▶



Weight: 382g
Sales lot: 1pc

■ Dimension

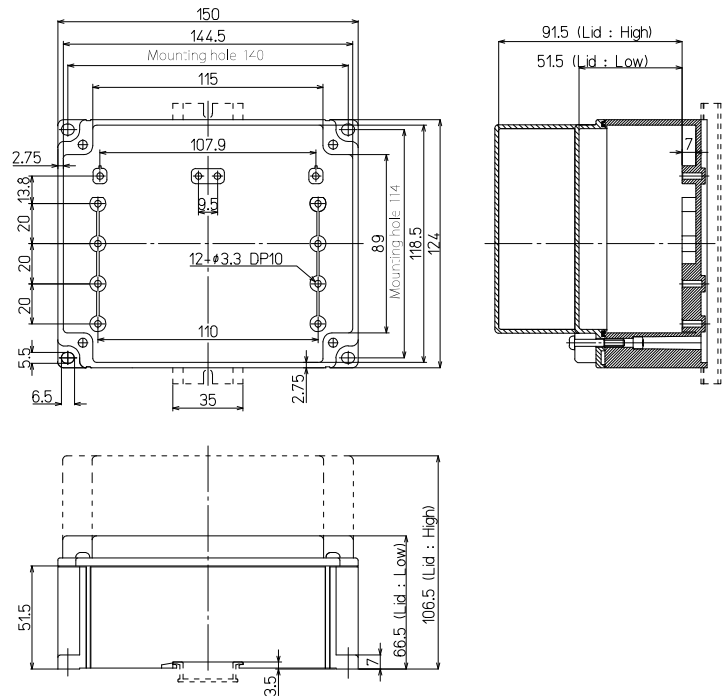

BOXTM-221L

IP67

600V / 15A / 2mm² [Screw size M3.5] / 22poles

Lid height: Low type ▶



Weight: 401g
Sales lot: 1pc

BOXTM-221H

Lid height: High type ▶



Weight: 475g
Sales lot: 1pc

■ Dimension

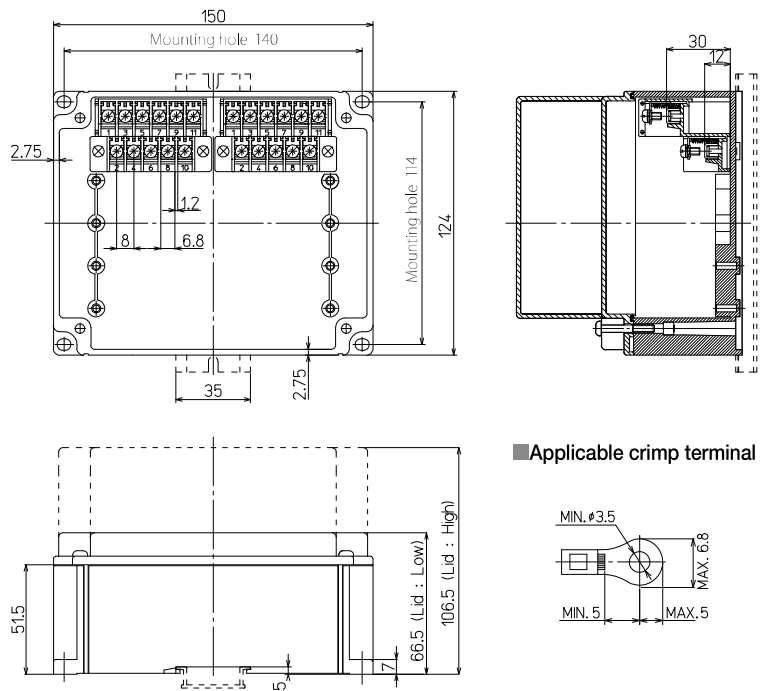

■ Applicable crimp terminal

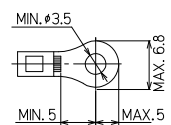

■ Applicable Short bar

BB8A-2, 4, 6 (see P.36)